

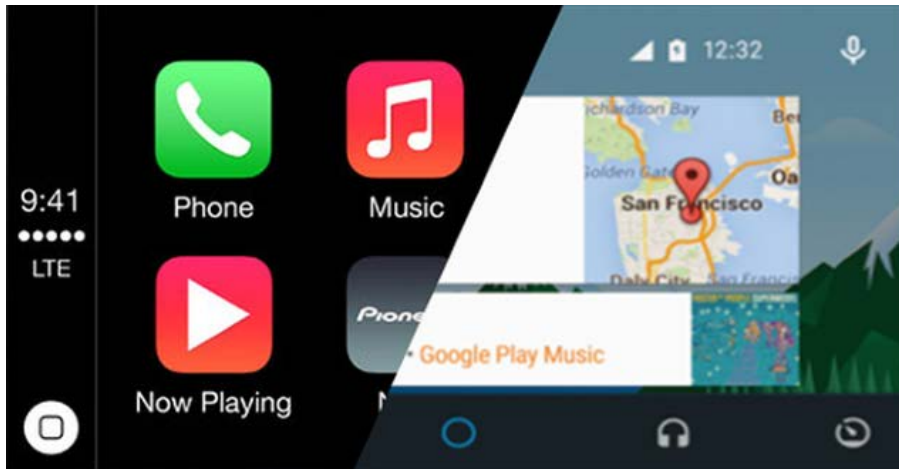

Installation Guide

CarPlay Integration for BMW NBT-EVO



Model No.	BMW-EVO-CP
MB-SW Ver.	060603
CP-SW Ver.	C7.1
Manual Ver.	1.0
Date	Nov. 30. 2018

Content:

● Warning	3
● Compatibility	5
● Features	6
● Package Components	7
● Connection Diagram	8
● DIP Setting	10
● Operation Instruction	11
■ How to switch from original to add-on interface	11
■ Apple CarPlay	12
■ Android Auto	13
■ Mirroring	14
■ USB Multimedia Playback	14

Warning:

- In order to protect the driving safety and avoid break the traffic law; please DO NOT operate the interface while driving.
- The reversing surveillance function just is used in reversing assistance. Please check the entire surroundings while reversing.
- All steps of installation should be done by the well-trained specialist.
- During installation, the ignition key should be taken off and after all installation finished, connect power cable last.
- Please DO NOT plug or pull the connected cables in the state of power-on, in order to avoid damaged monitor or accessory.
- Install wiring in a manner in which cables will not come in contact with metal parts. The wiring may be damaged by contact with metal parts, resulting in fire and shocks. Avoid all contact with hot surfaces when wiring the main unit. High temperatures may damage wiring, causing shorts, arcing and fires.
- Please DO NOT put the product in the damp environment or water, in order to avoid electric shock, damaged and fire accident caused by a short circuit.
- Kindly check all components are in the box when receiving the product. If anything missing, inform to the supplier/manufacturer.
- Start the engine before loading, check the interface whether have function displayed, key control whether correct, the vehicle

interface whether having a scratch. Please give the feedback to the supplier/manufacturer if there have any questions.

- Please note that put the disassembled automotive components in a good way on the installation process, avoid scratching the instrument panel, the leftovers of connecting cables need to handle and DO NOT leave it in the car. The connecting plug must be insulated in order to short circuit.
- The cables should be connected in a good way; the vehicle installation space is a little small, so reduce space usage as far as possible. There should be a good plan about connect cables, avoid affecting the active component of connecting, such as control components of turning the steering wheel, throttle and brake pedal. There need to be fastened after connecting cables in case of a drop.

Compatibility:

Brands	Class	Years	Original System
BMW	1 Series (F52)	2017 -	<p>NBT-EVO system ID5 & ID6 with/without OEM touch screen 6.5/8.8/10.25 inch monitor 6 Pin LVDS connector</p> 
	2 Series (F22, F45)		
	3 Series (F30, F31)		
	4 Series (F32, F33)		
	5 Series (G30)		
	7 Series (G11, G12)		
	X1 (F48)		
	X3 (F25)		
	X4 (F26)		
	X5 (F15)		

NOTE! OEM monitors with and without a touch screen are supported. But OEM touch could not operate the add-on CarPlay integration, please use iDrive controller instead.

Features:

- Integrated 3 in 1 module supports Apple CarPlay, Android Auto, and screen mirroring functions
- Supports USB HD video and lossless music playback (APE, WAV, FLAC, MP3, WMA, etc.)
- Offers 2 CVBS in (1 CVBS video for reverse camera, 1 CVBS A/V in for front view camera or additional A/V devices)
- Support PDC (Parking Distance Control) and FPG (Flexible Parking Guidelines)
- Supply 12V power to the backup camera
- Display front view camera automatically when shifted from “R” gear (DIP setting)
- VGA input for specific 360 panoramic system, offers a clearer picture
- Operate by OEM iDrive controller & steering wheel buttons (OEM touch could not support)
- Support further software update



Apple CarPlay



Android Auto



Mirroring



USB multimedia



FPG



PDC



2*CVBS in



Software update

Package Components:



Main Unit

Dimension: 141*98*29 mm

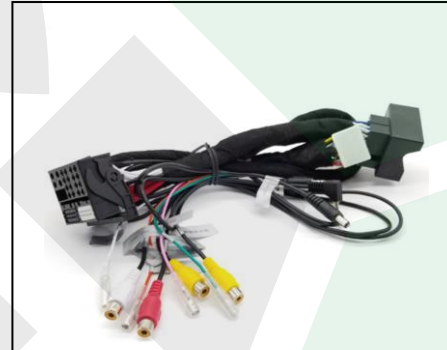

Quadlock Main Power Cable



6 pin LVDS Cable



AUX-USB adapter



USB/MIC Cable

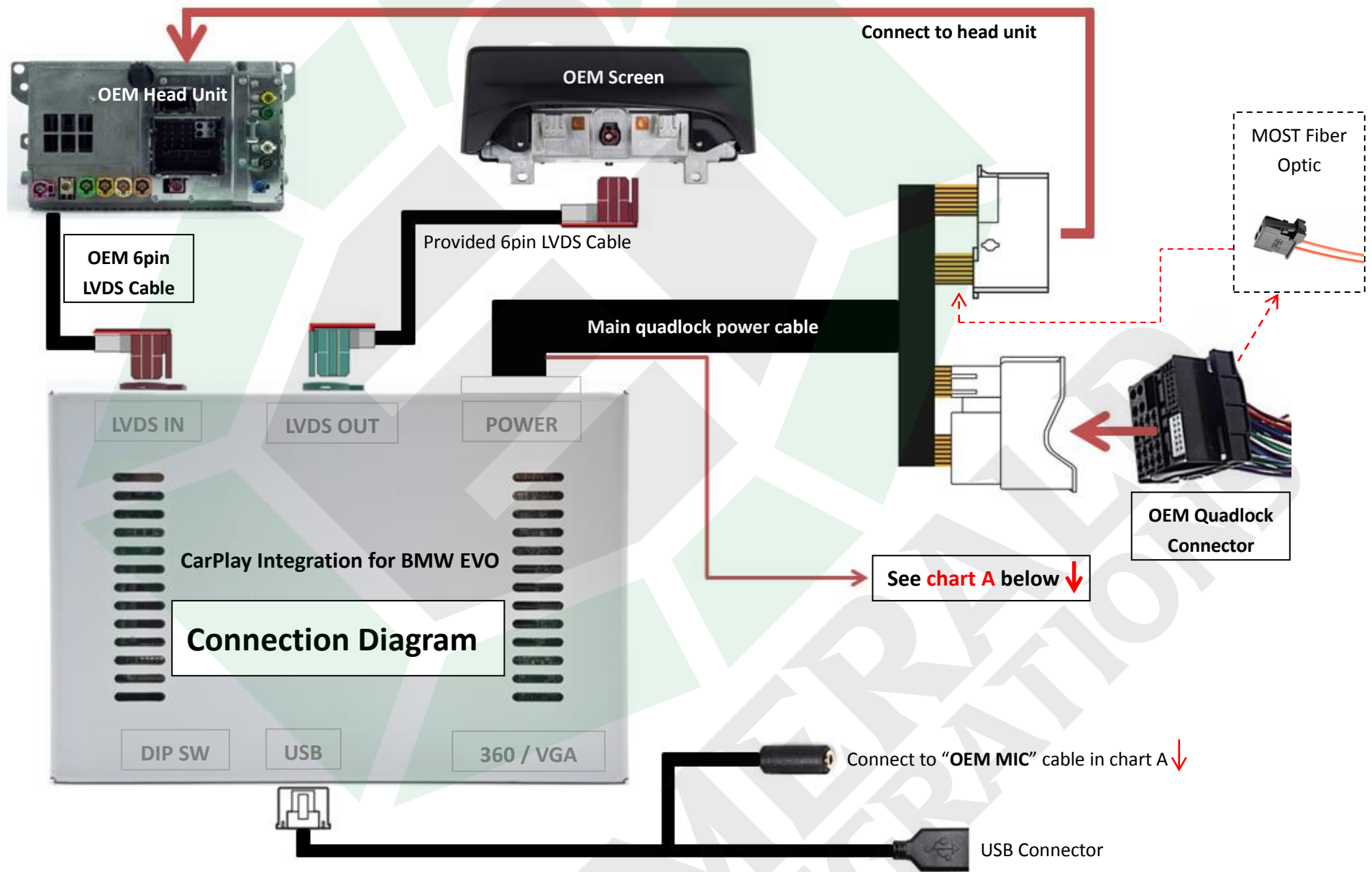

How to delivering audio to OEM radio

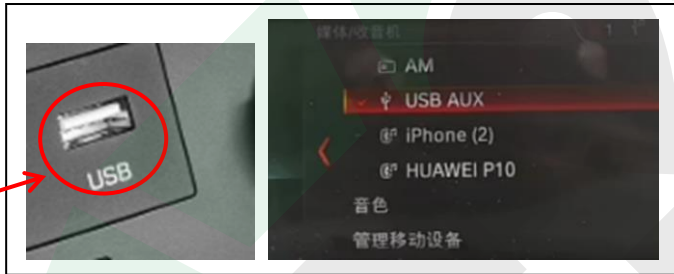
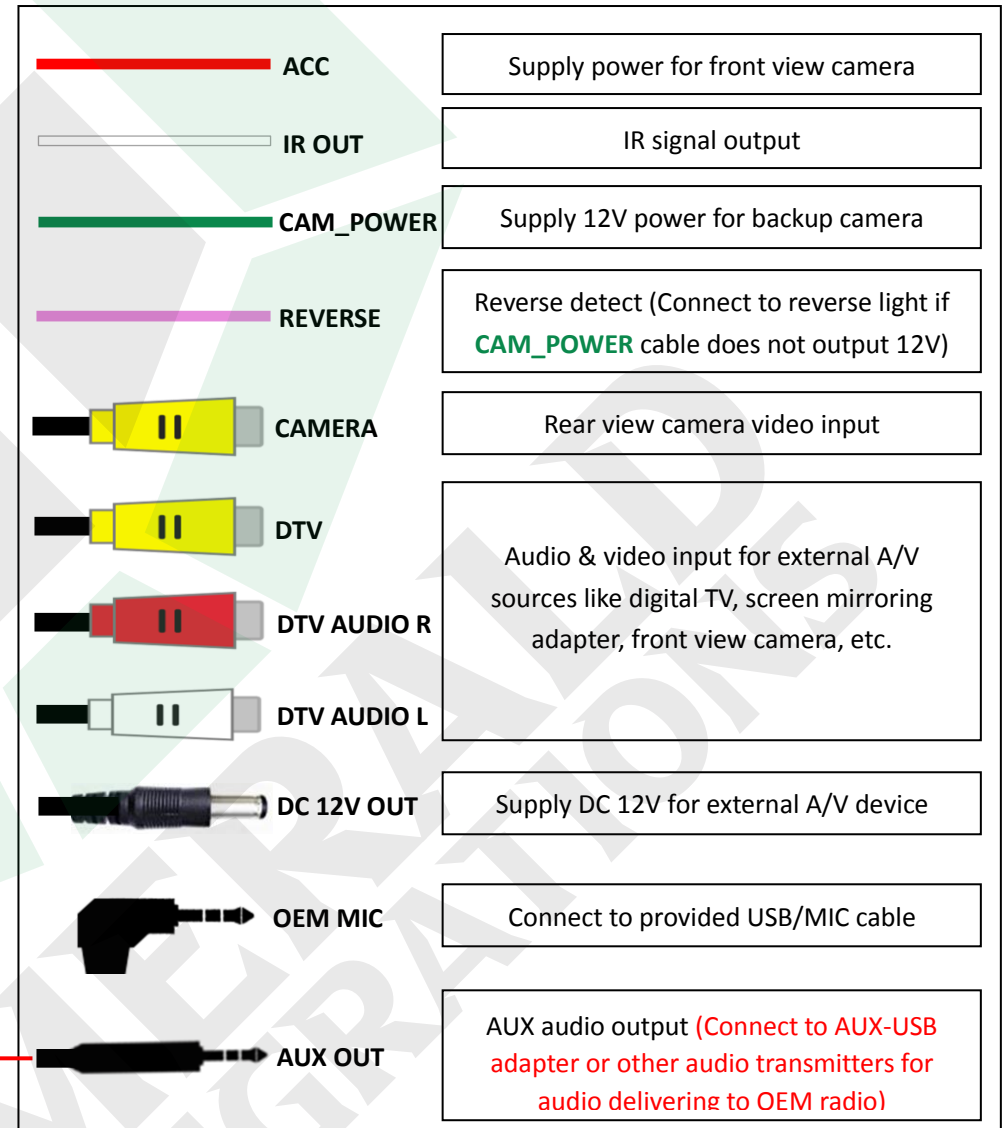

Chart A: ↓



*** PLEASE REFER TO THE BACK OF THE MODULE FOR THE LATEST DIP SETTINGS ***

DIP Setting:



PIN	ON ↑	OFF ↓
1	CAN2	CAN1 (Default)
2	Disable Dynamic Parking Guideline	Enable Dynamic Parking Guideline
3	Display front view camera for 10S automatically after shifted from "R" gear	Skip front view (Enter "DVR" icon to view picture)
4	CVBS	VGA
5	Enable PDC (Parking Distance Control)	Disable PDC (Full screen rear view camera)
6	Selection of monitor size	
7		
8	Original Rear View Camera	Aftermarket Rear View Camera

6	7	Resolution & Size
ON ↑	ON ↑	1440*540 (10.25")
ON ↑	OFF ↓	1280*480 (8.8")
OFF ↓	OFF ↓	800*480 (6.5")

NOTE! Please reboot the interface for effective after changing any DIP setting.

Operation Instruction:

- How to switch from Original to Add-on interface



Order: OEM - Add on - OEM



It will switch to add on module UI automatically when a phone/USB stick connected.



Click to exit front view camera picture

Add on module UI:

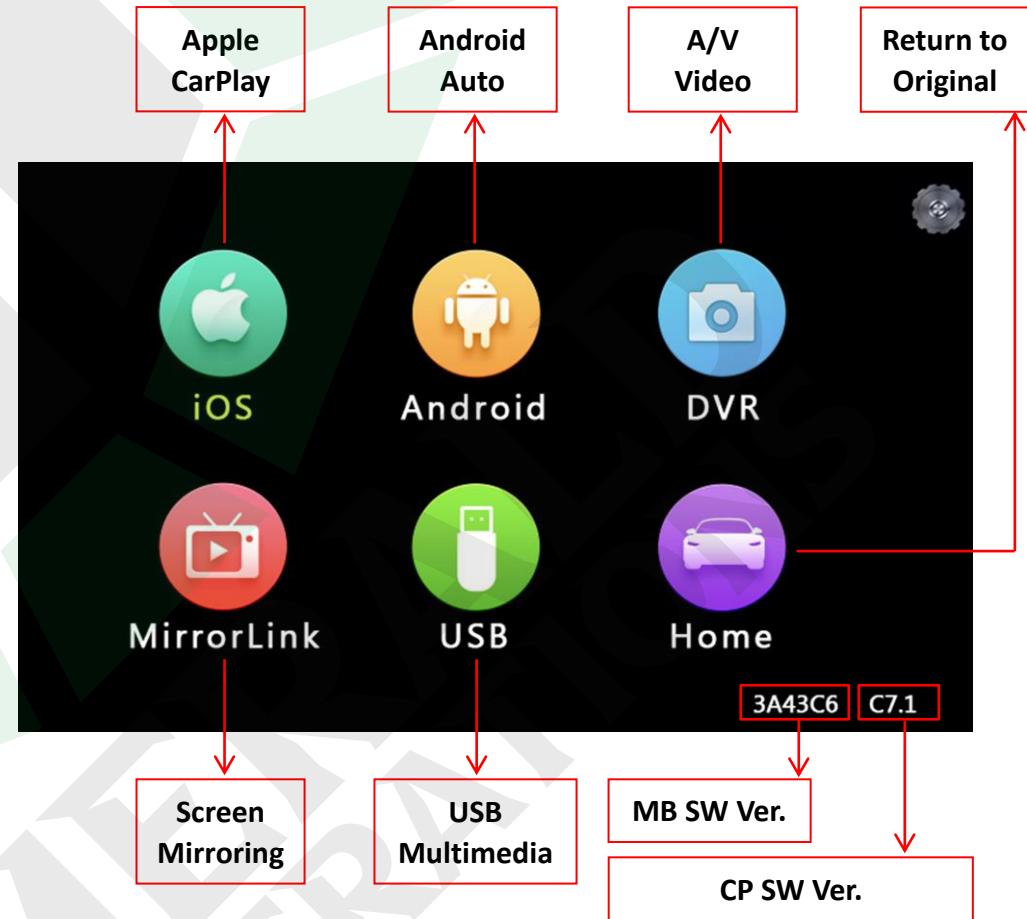

• Apple CarPlay

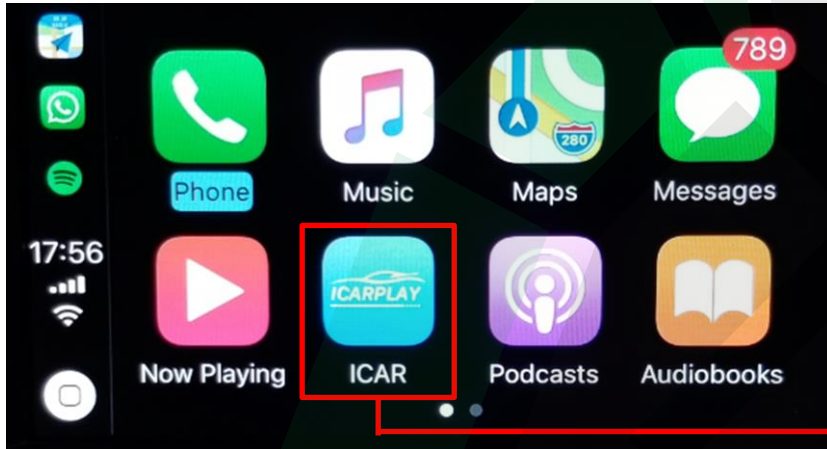

NOTE! Disconnect the Bluetooth connection between the phone and car stereo when using Apple CarPlay.



- ①: Click as home button; long press for switch mode: OEM-Add on-OEM
- ②: Turn the dial to move menu pointer
- ③: Answer/Hang up phone call
- ④: Click to activate Siri
- ⑤: Previous/Next song when playing music

● **Android Auto**

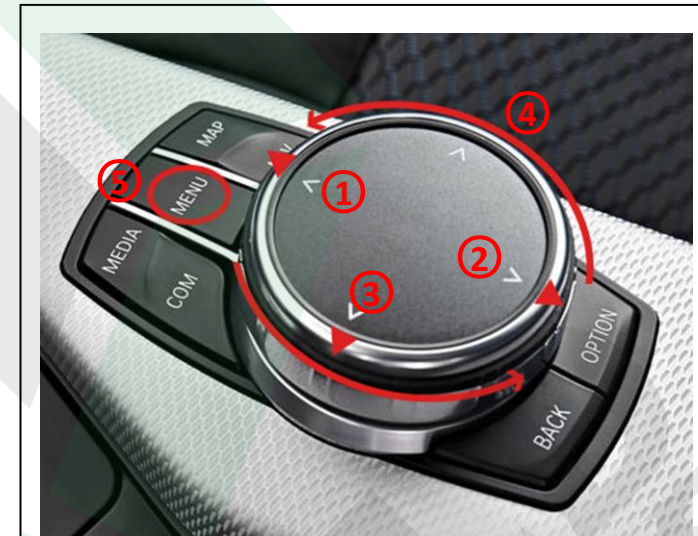
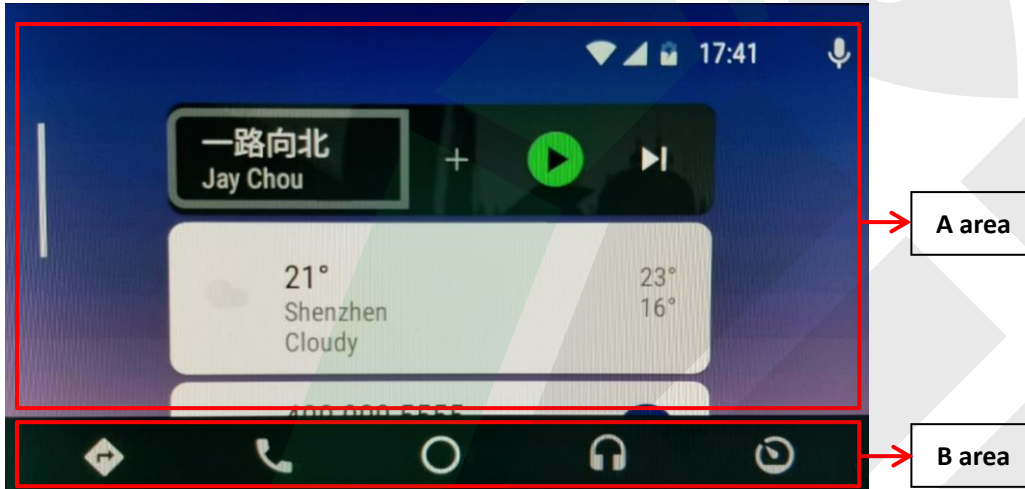

NOTE!

- Make sure smartphone connect to original car stereo Bluetooth for phone call audio delivering when using Android Auto.
- NOT available for activating **Google Assistant** with factory buttons, please use voice command "**OK Google**" instead.

- ①: Menu-pointer switch to **A area**
- ②: Menu-pointer switch to **B area**
- ③: Bring up the menu of upper left
- ④: Turn the dial to move menu-pointer
- ⑤: Long press for switch mode: OEM-Add on-OEM

● **Mirroring**



Connect Android smartphone/iPhone with USB cable, and then enter “MirrorLink” for screen mirroring.

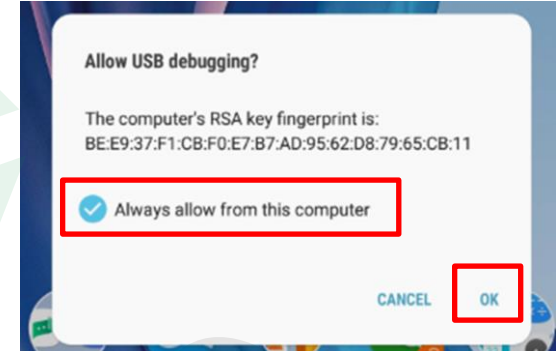
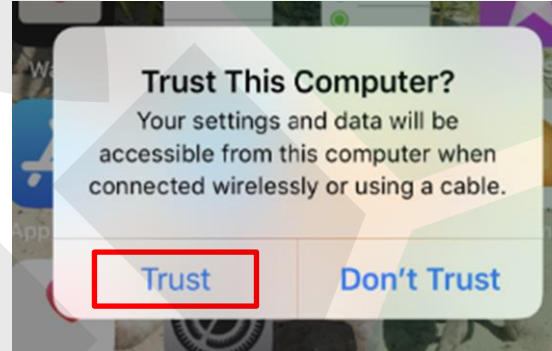

NOTE!

- Please always **trust or allow** when display a popup notification
- Enabling “USB Debugging” on an Android device
- Android device must connect to car stereo BT for all audio delivering

● **USB Multimedia Playback**



Connect a USB memory stick, enter “USB” icon for playing multimedia: Music, Picture, and Video.

Customer Service

At Emerald we want to make sure that you are completely satisfied, therefore we have assembled qualified associates to assist you. Our normal operating hours are Monday - Thursday 9:00 AM - 5:00 PM and Friday 9:00 AM - 4:00 PM (Pacific Standard Time).

Call us Toll Free: 844-333-3903

Email us: support@emeraldintegrations.com

Returns

30-Day Money-Back Guarantee

At Emerald Integrations, we want to make sure that you are completely satisfied. If for some reason you aren't happy with an item on your order and want to return it, we make returns and refunds extremely simple.

Any complete, like-new item returned within 30-days can be returned for a full refund less the original cost of shipping. All items or packages shipped free of charge will be subject to a \$15.00 shipping fee. If returned items are not in like-new condition, then Emerald Integrations may refuse a return or charge a restocking fee of 10% - 20%. Items not in like-new condition include, but are not limited to: items missing original item packaging, opened software or media items, used items, installed items, abused or physically damaged items, items missing parts, items damaged due to improper return shipping, items with a different serial number or defaced serial number, pre-cut wire, made-to-order items and special order items. All returns must be shipped back in a shipping carton, items cannot be shipped back in product boxes. Should you have any questions about our return procedure, please don't hesitate to contact us.

Return Disclaimer
Any unauthorized, improperly packaged, or non-insured packages will be returned to sender. Items that show signs of wear or have been, scratched, altered, or damaged in any way cannot be accepted for return

Warranty

Emerald Integrations understands that there are minor chances that electronics can fail and defects happen, in the event that this occurs, Emerald Integrations is here to help you quickly resolve your defect for a full year of 1-Year Warranty Coverage. Unlike others who push you to a manufacturer service center that can be slow and unresponsive, we're here to help with the repair or replacement you need. To begin the process, follow the instructions on the returns page at www.emeraldintegrations.com/returns.

The terms of the warranty are subject to the specific manufacturer and all expressed and implied warranties are provided solely by the manufacturer. Every item approved for a warranty claim is inspected by our team of qualified experts and professionally tested.

Emerald Integrations is a retail and wholesale distributor of vehicle electronic components, specializing in car safety. Emerald tests each product individually to ensure optimal performance and is NOT responsible for any negligence or damages caused by the installation process. Should a customer request assistance in finding an installer, Emerald holds no liability for any installers recommended by Emerald, it's employees or affiliates.